

BLDG. DEPT. SUBMITTALS:
ISSUED FOR BIDDING:
PLAN CHECK APPROVAL:
ISSUED FOR CONSTRUCTION:
REVISIONS:

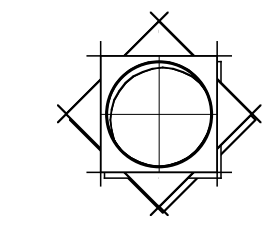

**McNeely & Moore**  
ARCHITECTURE

151 KALAMUS DRIVE  
SUITE C-100  
COSTA MESA, CA 92626  
PH: 714.444.9115  
FAX: 714.444.9113

**KENYA ORPHANAGE**  
KENYA, AFRICA

**SCHOOL**

JUNE 8, 2004

SHEET

**A2**

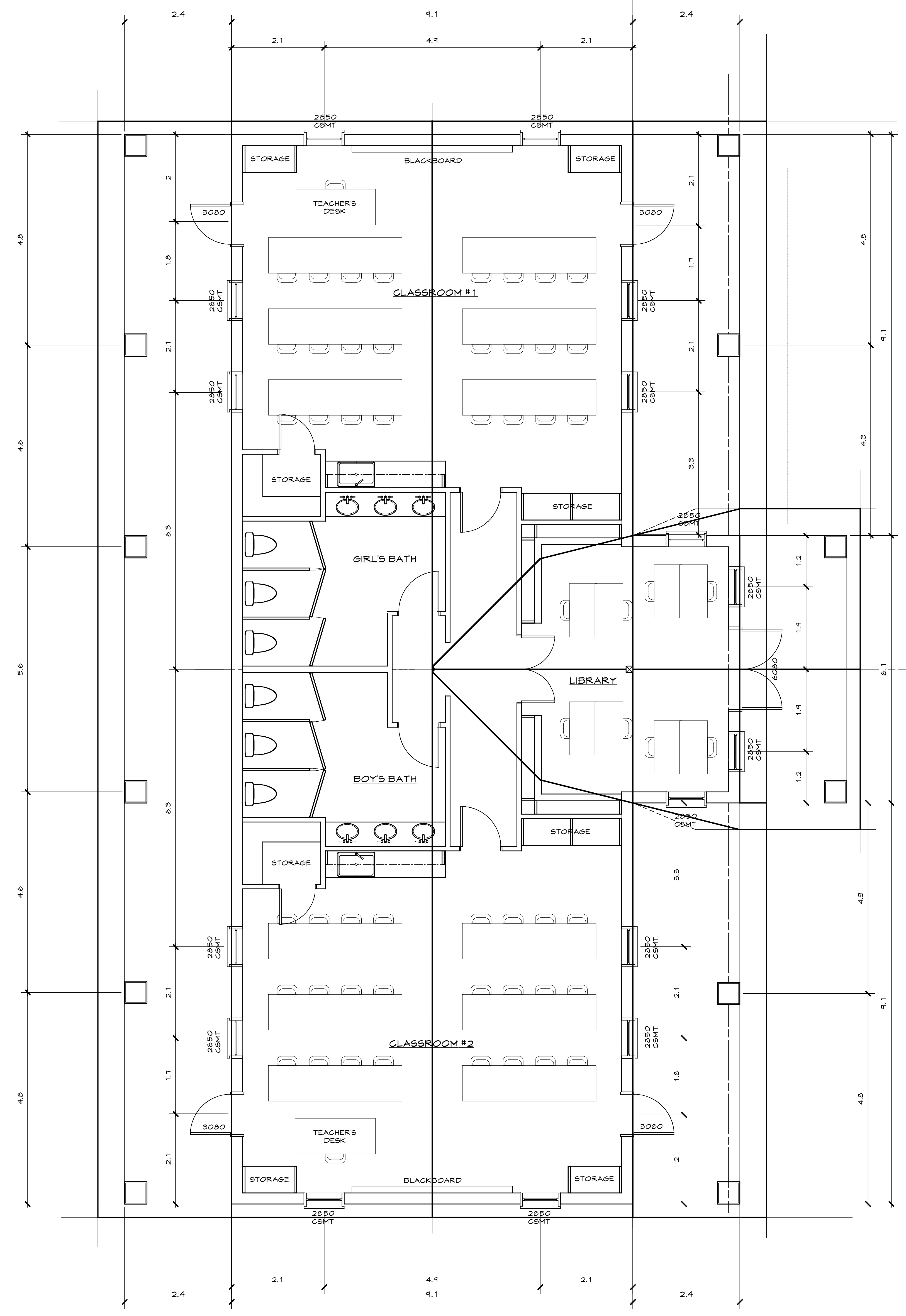

**SCHOOL / LIBRARY**

SCALE: 1:48